

digitech

Ultrasonic Cleaner

70W - 1800mL



Model:
YH5416

Instruction Manual

WARNING

1. Always unplug this product immediately after using.
2. Do not use while bathing.
3. Do not use the device without water.
4. Do not place the device in wet environment.
5. Do not reach for a product that has fallen into water. Unplug immediately.
6. Never operate this product if it has a damaged cord or plug.
7. Use this product only for its intended use as described in this manual. Do not use attachments not recommended by the manufacturer.
8. When the device works continuously for 8 minutes, please stop it for at least 5 minutes and then you can restart it.
9. This appliance can be used by children aged from 8 years and above if they have been given supervision or instruction concerning use of the appliance in a safe way and if they understand the hazards involved. Cleaning and user maintenance shall not be made by children unless they are aged from 8 years and above and supervised. Keep the appliance and its cord out of reach of children aged less than 8 years. Children shall not play with the appliance.
10. If the supply cord is damaged, it must be replaced by the manufacturer or its service agent or a similarly qualified person in order to avoid a hazard.

PARTS DESCRIPTION:

- A. Housing
- B. Inner Bowl
- C. Lid
- D. Buttons
- E. Power cord
- F. Blue Interior light
- G. LED Display
- H. Indication Light

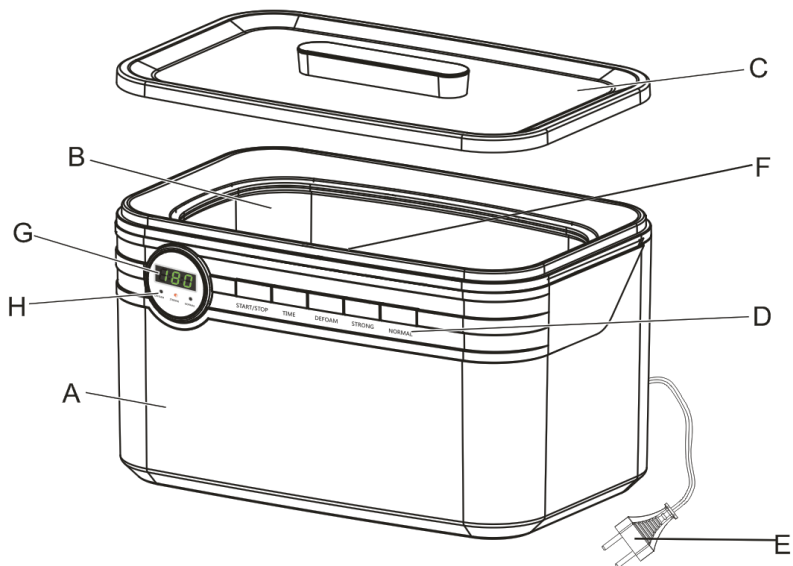

SPECIFICATIONS:

Product Name:	Ultrasonic Cleaner
Power Supply:	220-240V-50/60Hz
Timer Setting:	90s/180s/280s/380s/480s
Tank Volume:	1800mL
Power Consumption:	40W/80W

SCOPE OF USE:

Jewelry:	Necklaces, rings, earrings, bracelets, watchband, etc.
Metal Items:	Watch/clock components, coins, medals, badges, valves, parts of devices, etc.
Stationery:	Pen nibs, ballpoint pen sleeves, printer nozzles, signature stamps etc.
Daily Life Items:	Glass, toothbrushes, denture, braces, shaver head etc.

The following items are NOT suitable for ultrasonic cleaning:

Wood, pearls, leather goods, clock/watch mechanisms.

OPERATION INSTRUCTIONS:

- 1.** Fill with water: put the cleaning time inside and pull water inside the container (not exceed the MAX mark)
- 2.** Working time: press “timer” button to setting the working time (Startup default time is 180S, From 180S - 280S - 380S - 480S - 90S as recycle)
- 3.** Working mode: press “defoaming”, “strong” or “weak” button to setting the working mode. (Startup default working mode is strong). Defoam mode: working 5S, then stop 3S as cycle working. Strong mode: cleaning dirty items. Weak: cleaning soft or easy broken items.
- 4.** Start cleaning: Once time and working mode were set. Press “ON/OFF” to start cleaning. Timer will start countdown. When display “000”, means the program is finished.

Tips of operation:

- A.** You can press “ON/OFF” button to stop the machine during working.
- B.** During the working, you could change its working mode by “defoam”, “strong” or “weak”.
- C.** To avoid overheating, if the cleaner has run continuously for 480 seconds (8 minutes), rest the unit and do not use for the next 10 minutes..
- D.** Cut off the power and clear the water.

OPERATION INSTRUCTIONS:

Timer setting with 5 level timer control



Three cleaning methods (in different situations)

1. General Cleaning

Use just simple water for general cleaning (the water should cover the item but not exceed the Max mark)

2. Enhanced Cleaning

For special cleaning, add a few drops of cleaning liquid to enhance cleaning.

3. Partial Cleaning

To clean parts of large items, the device can be used with the lid open, as shown in the picture.

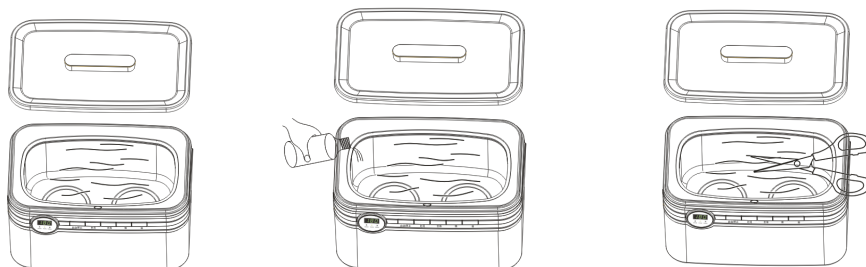

OPERATION INSTRUCTIONS:

How to clean watch strap & jewelry

1. Watch strap cleaning:

You can use the holder for cleaning metal watch straps. First, simply fix the watch strap onto the holder, with the watch part face up; second, put the holder into the container which is filled with water.

2. Jewelry cleaning:

First, put the jewelry into the holder; second, put the holder into the inner bowl which is filled with water. After cleaning, take out the holder and dry the jewelry with clean dry cloth. The jewelry can be restored to a gleaming finish.

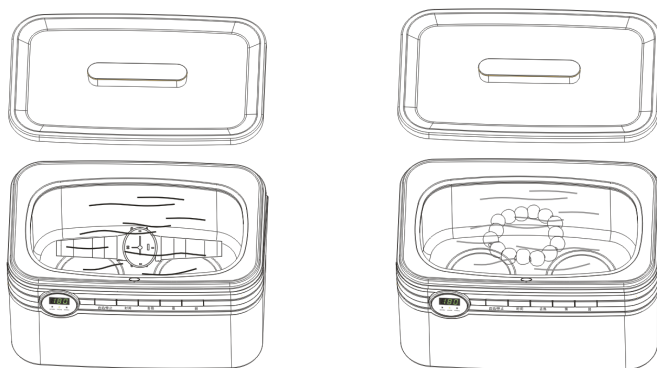

MAINTENANCE:

1. Do not clean the ultrasonic cleaner with harsh cleaning products or sharp objects.
2. Keep the device in a cool, dry place, well out of reach of children.
3. Do not leave water in the cleaning container. Empty immediately after each use.
4. Wipe the cleaning container with towel. Avoid washing the complete unit with water to reduce the risk of electrocution.

TROUBLESHOOTING:

Problem Fault	Possible Cause	Remedy
The unit does not turn on	The device is not plugged in or not properly plugged in	Insert the plug firmly in the socket
	The mains cord is faulty	Have the device to be repaired
The item is still dirty after cleaning process	There is no water or not enough water in the tank	Add water to the tank until it reaches the "Max" mark
	No cleaning product added	Add a cleaning product depending on type of dirt

WARRANTY INFORMATION:

The manufacturer provides warranty in accordance with the legislation of the customers' own country of residence, with a minimum of 1 year (Germany: 2 Years), starting from the date on which the appliance is sold to the end user.

The warranty only covers defects in material or workmanship.

The repairs under warranty may only be carried out by an authorized service.

When making a claim under the warranty, the original bill of purchase (with purchase date) must be submitted.

The warranty will not apply in case of:

- Normal wear and tear
- Incorrect use, e.g. overloading of the appliance, use of non-approved accessories
- Use of force, damage caused by external influences
- Damage caused by non-observance of the user manual, e.g. connection to an unsuitable mains supply or non-compliance with the installation instructions
- Partially or completely dismantled appliances



This marking indicates that this product should not be disposable with other household wastes throughout the EU. To prevent possible harm to the environment or human health from uncontrolled waste disposal, recycle it responsibly to promote the sustainable reuse of material resource. To return your used device, please use the return and collection systems or contact the retailer where the product was purchased. They can take this product for environmental safe recycling

Distributed by:
Electus Distribution Pty. Ltd.
320 Victoria Rd, Rydalmere
NSW 2116 Australia

www.electusdistribution.com.au

Made in China